

Repair Parts Sheet	Revision	Revision Date	Product Code Beginning
L3018	Rev. C	01/2011	B

Fig. 1, Cylinder Assembly

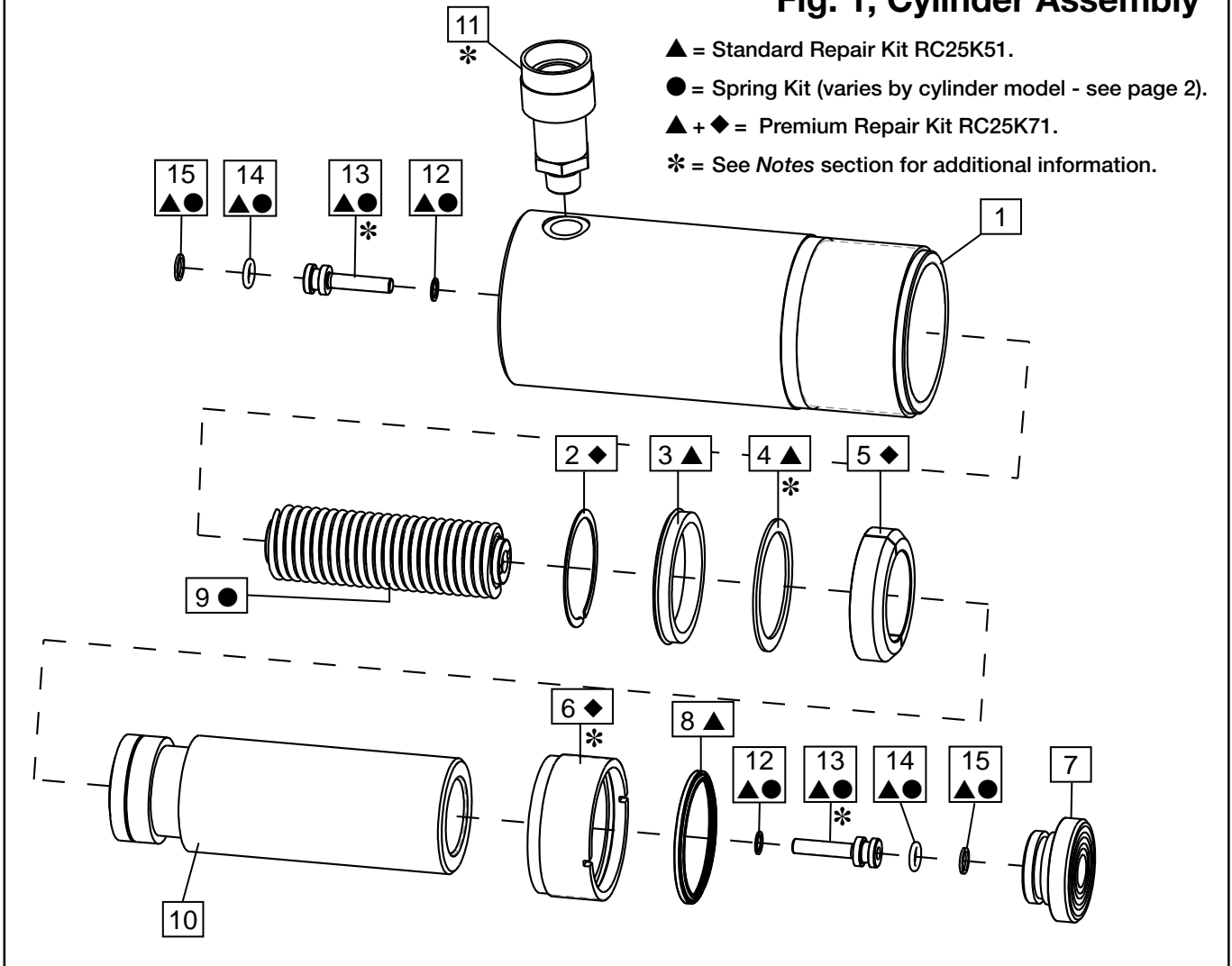

**Note: See Page 2
 for parts list.**

(*) Notes	
Item	Torque / notes
4	Washer to be placed with the sharp edge towards U-Cup.
6	7.9 - 10.2 Nm, 70 - 90 In - Lbs
6	Secure with Loctite 222.
11	54 - 81 Nm, 40- 60 Ft - Lbs
11	Use Loctite 545 or Teflon tape.
13	10.2 - 12.4 Nm, 90 - 110 In - Lbs

Repair Parts List, Figure 1

L3018

Item	Description	Qty.	Part Number		
			RC-251	RC-252	RC-254
1	Base	1	(not available)	(not available)	(not available)
2	Retaining Ring	1	▲	▲	▲
3	U-Cup	1	▲	▲	▲
4	Washer	1	▲	▲	▲
5	Rod Bearing	1	◆	◆	◆
6	Stop Ring	1	◆	◆	◆
7	Saddle, Grooved	1	A252G	A252G	A252G
8	Wiper Ring	1	▲	▲	▲
9	Spring	1	●	●	●
10	Plunger	1	(not available)	(not available)	(not available)
11	Coupler	1	CR-400	CR-400	CR-400
12	Gasket	2	●▲	●▲	●▲
13	Spring Retainer	2	●▲	●▲	●▲
14	O-Ring	2	●▲	●▲	●▲
15	Ring, Back-up	2	●▲	●▲	●▲
N/S	Dust Cap	1	▲	▲	▲
N/S	Thread Protector	1	▲	▲	▲
N/S	O-Ring Coupler	1	▲	▲	▲
N/S	Enerpac Decal	1	▲	▲	▲
N/S	Warning Decal	1	▲	▲	▲
N/S	O-Ring Saddle	1	▲	▲	▲
▲	Repair Kit, Standard	-	RC25K51	RC25K51	RC25K51
◆ + ▲	Repair Kit, Premium	-	RC25K71	RC25K71	RC25K71
●	Spring Kit	-	RC25K31	RC25K32	RC25K33

Notes:

Premium repair kit includes all standard (▲) repair kit items plus additional premium (◆) items.

N/S = Item not shown.

Cylinders with Viton components only: Order Repair Kit RC2510KV in addition to Repair Kit RC25K51 or RC25K71. Repair Kit RC2510KV includes Viton components for items 3 and 8. Standard components are used in other locations.



To maintain your warranty:

- Use only Enerpac Oil
- Have your products inspected and repaired by an Enerpac Authorized Service Center

ENERPAC

Visit www.enerpac.com for the location of the Enerpac Authorized Service Center nearest you.